

Safety Instructions

1,2,3,4,5,6,8,12,17,18,19,
24,33,34



Info Hotline



+49 (0) 5041 998 389

Mon. - Do. 7⁰⁰ - 20⁰⁰
Fr. 7⁰⁰ - 17⁰⁰

Paulmann Licht
GmbH Quezinger
Feld 2
31832 Springe
Germany

www.paulmann.com

Art.-Nr.: 952.91
952.92
952.93



952.91
952.92



(+MA326)PBO 11/16



952.93

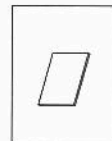
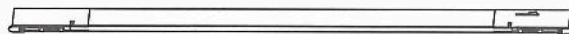

incl.

A1

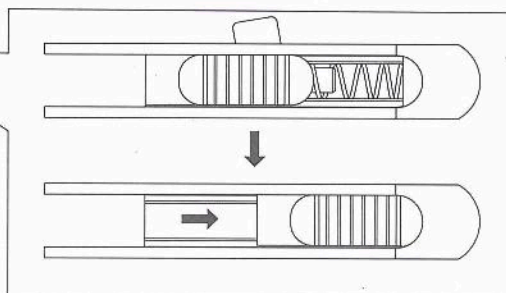
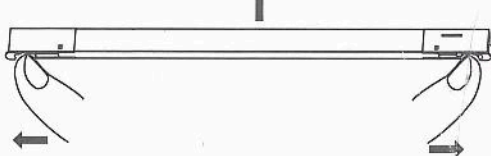
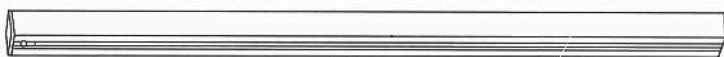

Safety
Instructions
Nr.5



A2

952.93



2

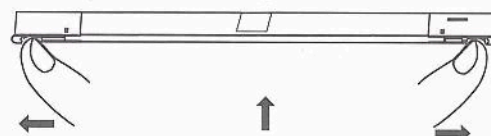

1

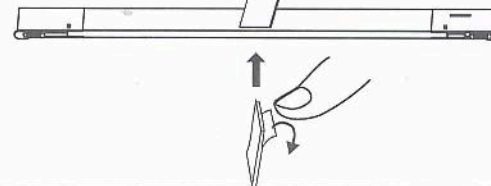

Safety
Instructions
Nr.5



B

